



MASS COORDINATE SYSTEM
 INCLUDING ZONE, REGION
 IDENTIFICATION CODES BY
 STATE AND COUNTY AND
 STATE COLLECTION DATE
 INFORMATION

RESERVED FOR REGISTRY USE

I CERTIFY THAT THIS PLAN HAS BEEN
 PREPARED IN CONFORMANCE WITH THE
 RULES AND REGULATIONS OF THE
 REGISTRY OF DEEDS OF THE
 COMMONWEALTH OF MASSACHUSETTS.



ALAN M. GRADY, PLS
 MASSACHUSETTS REG.
 NO. 3732

Line #	Bearing	Distance
L1	N 14° 41' 40" W	7.87'
L2	S 14° 41' 40" E	7.87'
L3	N 73° 05' 53" E	72.58'
L4	S 16° 27' 09" E	7.32'
L5	N 73° 10' 48" E	61.02'
L6	N 13° 11' 25" W	6.92'
L7	N 71° 11' 07" E	55.28'
L8	N 20° 42' 53" N	4.07'
L9	N 68° 53' 54" E	27.73'
L10	S 77° 31' 49" E	57.81'
L11	S 13° 30' 41" W	3.10'
L12	S 13° 30' 41" N	3.10'
L13	N 7° 41' 55" W	3.29'

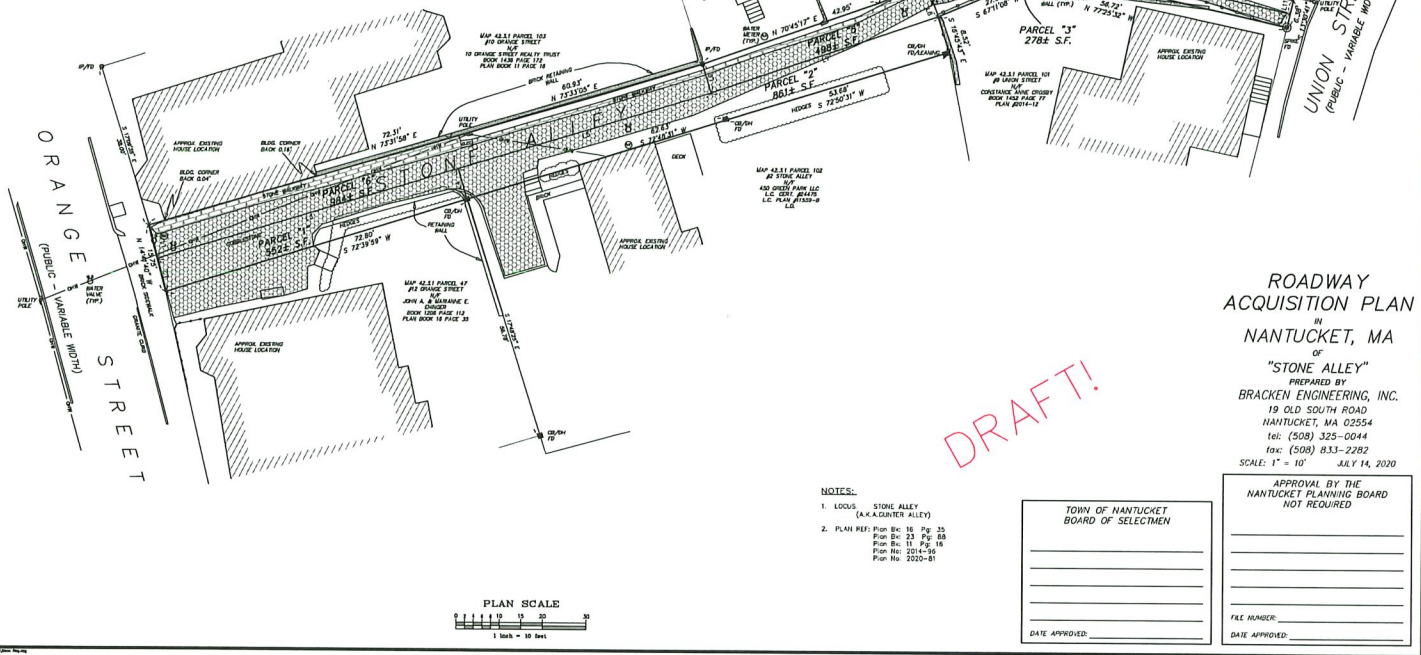
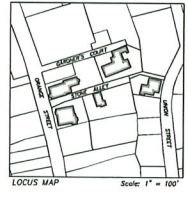

ROADWAY
 ACQUISITION PLAN
 IN
 NANTUCKET, MA
 OF
 "STONE ALLEY"
 PREPARED BY
 BRACKEN ENGINEERING, INC.
 19 OLD SOUTH ROAD
 NANTUCKET, MA 02554
 TEL: (508) 325-0044
 FAX: (508) 833-2282
 SCALE: 1" = 10' JULY 14, 2020

- NOTES:
- LOCUS: STONE ALLEY (AKA: KASBURY ALLEY)
 - PLAN REF: Plan Bk: 16 Pg: 35
 Plan Bk: 23 Pg: 55
 Plan Bk: 11 Pg: 16
 Plan No: 2014-36
 Plan No: 2020-81

TOWN OF NANTUCKET
 BOARD OF SELECTMEN

DATE APPROVED: _____

APPROVAL BY THE
 NANTUCKET PLANNING BOARD
 NOT REQUIRED

DATE APPROVED: _____

